

How to run NestLeader under Win7

NestLeader would crash when you create material or set nest parameter under Win7. It is because of the Win7 UAC control. Here is the method to avoid the issue.

1. Go to NestLeader folder \TAOSoft\NestLeader 2.5
2. Right click the exe file launcher.exe
3. Select the properties

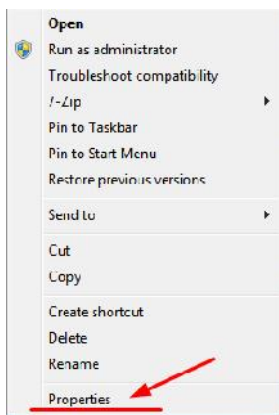

4. Check on the option in Privilege Level section

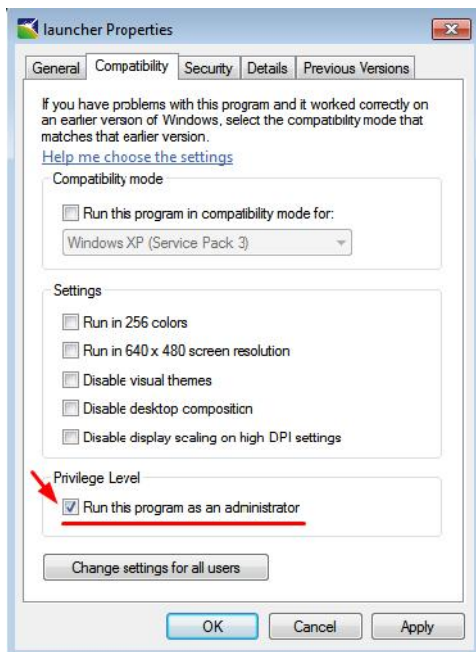

5. Apply the setting and run the exe now, the crash issue won't happen again.

Supports:

<http://www.cutleader.com/support/>